

INTRUSION-MINIMIZING BRAKE PEDAL OPERATION

B3E041143300T02

- In a frontal collision, the brake pedal is forced rearward by the movement of the engine and other parts.
- Pedal arm section A of the rearward moving brake pedal contacts the cross-beam.
- Pedal arm section A rotates where it contacts the cross-beam, preventing rearward movement of the brake pedal.

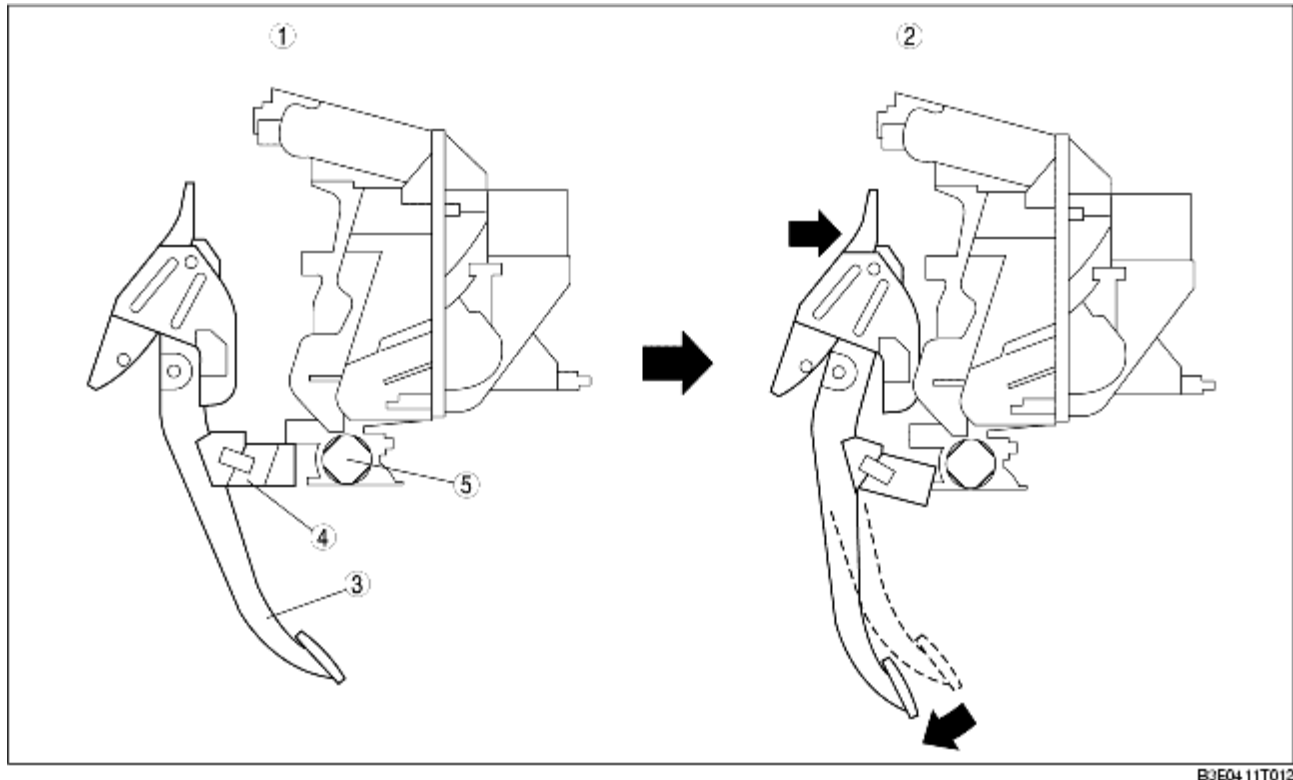

B3E0411T012

1	Normal condition
2	During collision
3	Brake pedal
4	Pedal arm section A
5	Cross-beam